

Fraser International Trading Inc.

TEL: 1-888-531-8383

EMAIL : fraserit@telus.net

<http://www.cleanrevolution.com>

CLEAN TOUCH

personal Hygiene Appliance

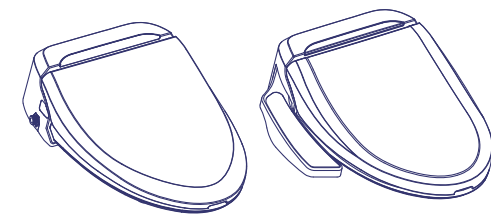

CLEAN TOUCH
**Operating
Instruction Manual**

*UB-6035R
UB-6235*



- Thank you for purchasing this product.
- Please read this operating manual carefully before use.
- Please save this manual and place in an easily accessible location.

**THIS UNIT IS RECOMMENDED FOR PROFESSIONAL INSTALLATION.
READ ALL OPERATING INSTRUCTIONS BEFORE INSTALLATION.**

Notes

- 1. This product should be installed according to this manual.*
- 2. Please read this manual carefully and install properly.*
- 3. Please save this manual and place in an easily accesible location.*
- 4. Do not attempt to service this appliance yourself. Doing so could void the warranty.*
- 5. Do not sit or step on lid. Sit on seat only. Do not place any heavy objects on this appliance.*
- 6. Exposure to direct sunlight may cause ABS plastic to yellow.*

Table of Contents

PREPARATION

1. IMPORTANT SAFEGUARDS	1
2. CAUTIONS BEFORE INSTALLATION	2
3. PARTS	3

USE

6. HOW TO USE	4
7. HOW TO CLEAN	5
8. MAINTENANCE	6

INSTALLATION

9. HOW TO INSTALL	7
-------------------	---

ETC

10. TROUBLESHOOTING	8
11. SPECIFICATIONS	9
12. WARRANTY	

1 Important Safeguards

1. READ ALL INSTRUCTIONS BEFORE USING

DANGER - To reduce the risk of electric shock:

1. Do not place or store this appliance where it can fall or be pulled into a tub or sink.
2. Do not place in, or drop into water or other liquid.
3. Do not reach for a product that has fallen into water. Unplug immediately.

WARNING - To reduce the risk of burns, electric shock, fire or injury to persons.

1. Close supervision is necessary when this appliance is used by or near the very young or infirm.
Children should not be permitted to use or touch this appliance without the supervision of an adult.
Be sure to adjust all temperature settings to LOW for users who require assistance with this unit or people with sensitive skin.
2. Use this appliance only for its intended purpose as described in this manual. Do not use attachments not recommended by the manufacturer.
3. Never operate this appliance if it has a damaged cord or plug, if it is not working properly, if it has been dropped, damaged or dropped into water.
4. Install the unit properly by following the installation procedure.
5. Only authorized persons can install or repair the unit. Do not attempt to service this appliance yourself. Doing so could void the warranty.
6. Keep the cord away from heated surfaces.
7. Never drop or insert any objects into any opening or hose.
8. Do not use outdoors. Do not use aerosol or oxygen spray products on the unit.
9. Always follow the grounding instruction in this manual before plugging in the unit.

SAVE THESE INSTRUCTIONS

2 Cautions before installation

1. NOTE THE FOLLOWING IMPORTANT POINTS

1. Do not install in a location where water might be splashed on this appliance or in a location exposed to such excessive moisture that condensation forms on the products surface.
2. To avoid damage to electronic components due to high levels of humidity, provide adequate ventilation by opening a window and/or door when bathing. You may find operating an exhaust ventilating fan during these times of high humidity beneficial.
3. Use a water supply having a water pressure of 15 PSI -100 PSI.
4. Connect the product to a pipe carrying potable water. Do not connect to an industrial water line or other water supply that does not carry water of drinking quality.
5. In areas where water freezes in pipes in winter make arrangements to keep the pipes warm.
The water remaining in the unit may sometimes freeze during storage in winter. In that case, warm the unit in the room before installation.
6. The thermal protector in the water tank may sometimes trip during storage or transportation in warm weather causing non-operation. In that case, cool the unit in the room before installation.
7. The rated power voltage is 120V AC, 60Hz.
8. Do not supply electrical power to the unit until the plumbing installation work has been completed; it could cause malfunction.

2 Cautions before installation

2. WIRING REQUIREMENTS

1. Electrical servicing should be performed by an authorized service representative.

2. GROUNDING INSTRUCTIONS

This product must be grounded. In the event of an electrical short circuit, grounding reduces the risk of electric shock by providing an escape wire for the electric current. This product is equipped with a plug having a grounding pin. The plug must be plugged into a 3 prong GFI (Ground Fault Interrupt) outlet.

DANGER-Improper use of the grounding plug can result in a risk of electric shock.

Ground Fault interrupt(GFI) outlets are mandated by electrical code. GFI outlets should be tested monthly to ensure correct operation. Please see GFI manufacturer instructions for more information.

Check with a qualified electrician or serviceperson if the grounding instructions are not completely understood, or if in doubt as to whether the product is properly grounded.

3. This product is for use on a nominal 120V circuit, 3 prong Ground Fault Interrupt(GFI) outlet as illustrated in sketch A.

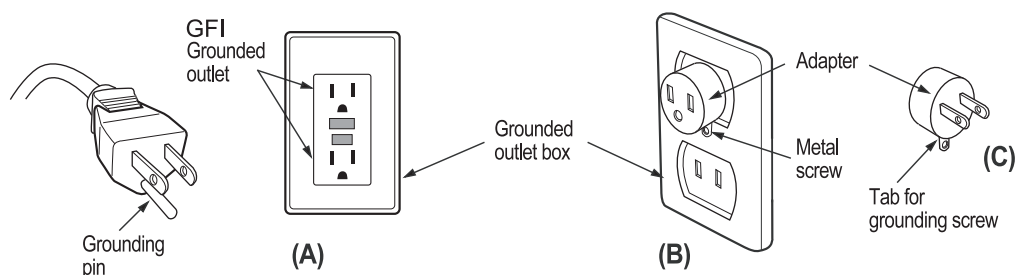

4. If it is necessary to use an extension cord, use only a three wire extension cord that has a three-blade grounding plug. Ensure extension cord is properly rated for this product.

5. Remote control power : AAA(1.5V) , 3EA

CAUTION

RISK OF EXPLOSION TO BATTERY IF REPLACED BY AN INCORRECT TYPE.

DISPOSE OF USED BATTERIES ACCORDING TO MANUFACTURER INSTRUCTIONS.

3 Parts

1. Main unit

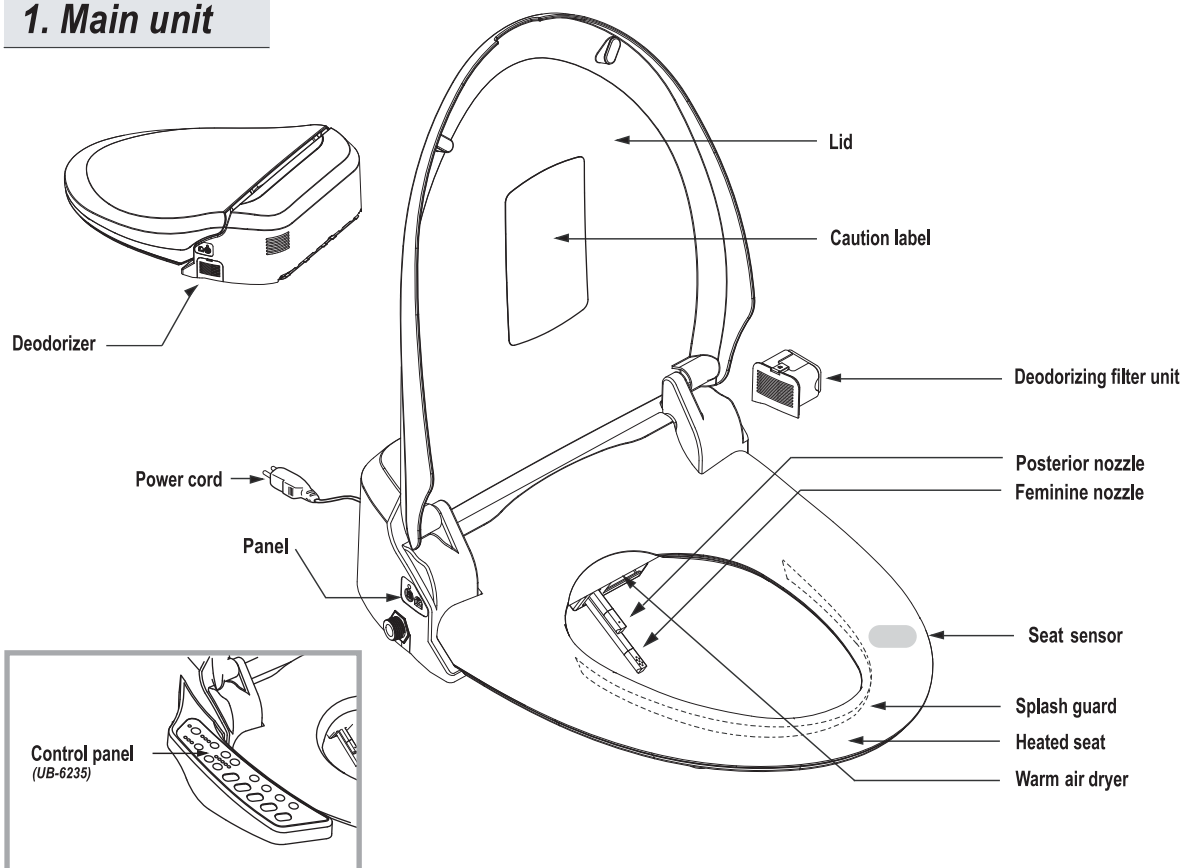

2. Accessories

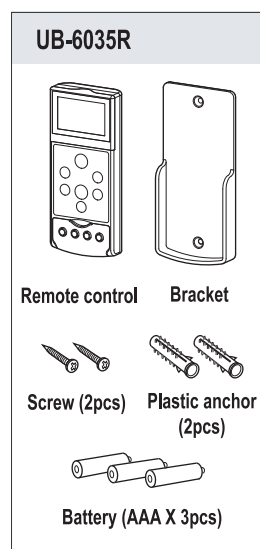
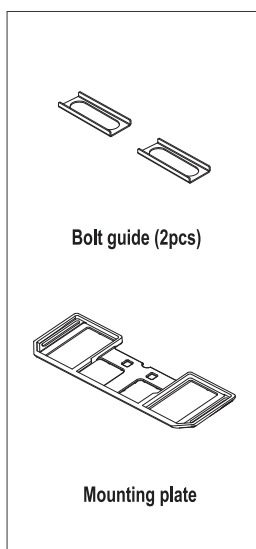
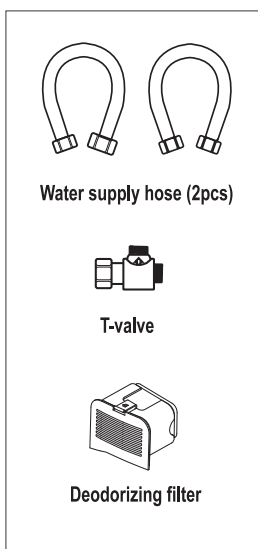
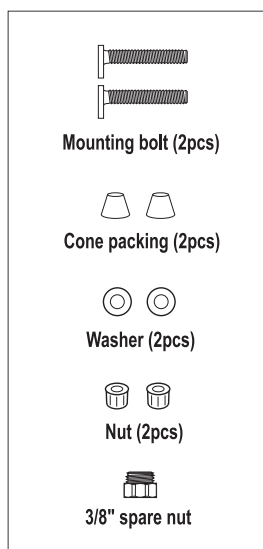

※Caution

- Do not drop a remote control in water. It may cause malfunction.
- All functions will be operational when the seat sensor is activated, except Nozzle Cleaning
- Before operating, ensure that water tank is filled up completely.

Stop

- Press "Stop" to stop current operation.
- When a user stands up, all operations will stop automatically.

Cleansing

- Press "Cleansing" to clean your posterior. The function will stop in 60 seconds automatically.
- Press this button again to activate oscillation. The nozzle moves back and forth automatically to widen cleansing area.
- Oscillation wash stops if this button is pressed again.

Bidet

- Press "Bidet" for feminine wash. The function will stop in 60 seconds automatically.
- Press this button again to activate oscillation. The nozzle moves back and forth automatically to widen cleansing area.
- Oscillation wash stops if this button is pressed again.

Dry

- Press "Dryer" after "Cleansing" or "Bidet".
- Warm air will operate out for 3 minutes.
- To alter the air dry temperature press this button again.

IIP (intensive impulse pulsation)

- Press "IIP" for impulse pulsation massage spray.
- The function will stop in 60 seconds automatically.
- Press "IIP" again to change the pulsation mode.

Kids

- Press "Kids" to change all functions for children.
- 1 minute for oscillation and 3 minutes for dry, level 1 water pressure and level 5 nozzle position will be set.
- This unit should be used under the supervision of an adult.

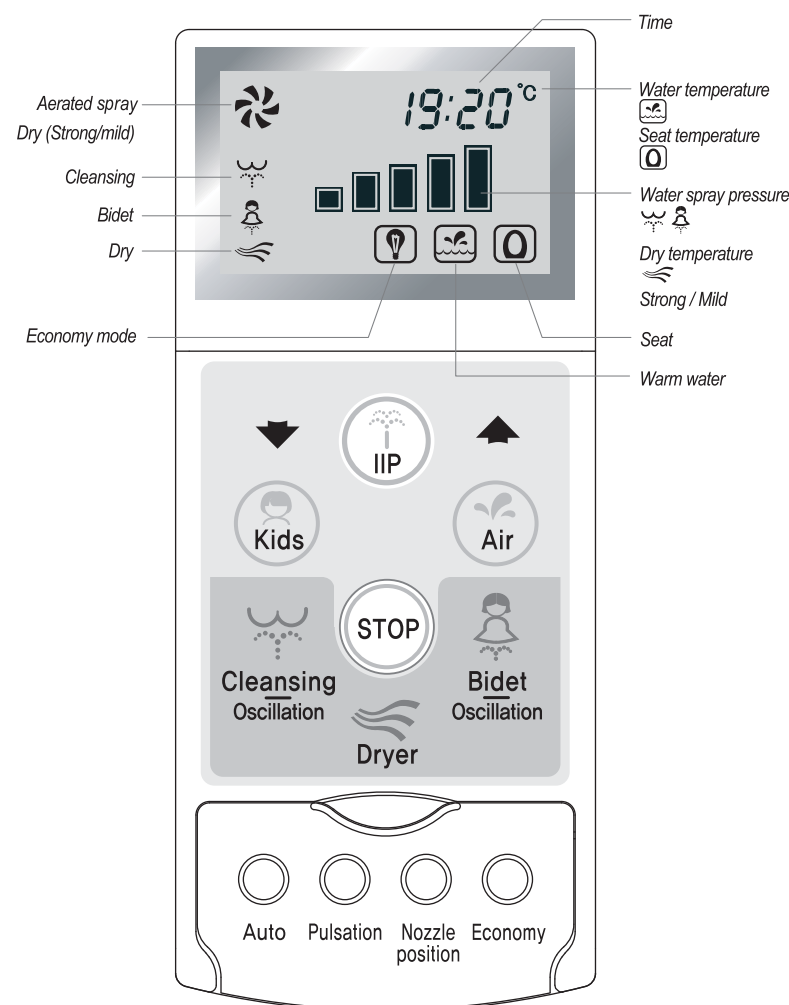

Air (aerated spray)

- Press "Air" to use aerated wash to clean. Gentle, delicate but strong water spray will save water consumption.
- Press this button again to release this function.
- "Cleansing" mode starts with this function on.

Water pressure / Dry temperature

- Press ▼·▲ arrows to adjust water pressure. 5 levels.
- Press ▼·▲ arrows to adjust dry temperature. 5 levels.
- Both levels default to 3.

Auto

- Press "Auto" during "Cleansing" operation.
- Wash, oscillation and dry will each operate for 20 seconds.
- For Auto Bidet, press "Bidet" and "Auto" consecutively.

Pulsation (massage)

- Press "Pulsation" to activate massage wash effect.
- Press "Pulsation" again to release this function.

Nozzle position

- Nozzle position can be adjusted 5 levels.
- Press ▼·▲ arrows to adjust.
- Position default to level 3.

Economy

- Press "Economy" to activate power saving function.
- In Economy mode, water and seat temperatures are kept to 30 degrees celsius.
- Bulb on the remote control and green light on the main unit panel will appear.
- When the unit is next used, temperatures will revert to default settings.
- Unit will revert to Economy mode after 1 hour of last use.
- Press "Economy" again to release this function. Red light will appear on the main unit panel.

Temperature adjustment (water / seat)

- Press "Water" or "Seat" buttons to adjust temperatures.
- 4 levels-room temperature, 34, 37, 40 degrees celsius.

Nozzle cleaning

- Ensure seat sensor is not activated.
- Press "Cleaning" button to clean posterior nozzle manually.
- Press "Cleaning" button again. to clean feminine nozzle manually.
- Press "Stop" to return nozzle to stand-by mode
- Refer to "How to clean" notes.

Time setting

- Time on the remote control is in 24 hours mode.
- To set the hour, press "Time" once and press ▼▲.
- Press "Time" again to set the minutes.
- Time will be re-set(00:00) if batteries are changed.

Automatic deodorization (If equipped)

- Deodorizer works automatically when appliance is in use. (max 20 minutes)
- Stops 60 seconds after use.

Self cleaning

- Nozzle self cleans before and after each use.

Self-diagnosis system

- This appliance has a self-diagnostic system, LED light on the unit will appear in case of malfunction.
- Unplug and contact service center immediately. if malfunction.

Main unit panels

- For use if remote control batteries are dead
- To turn off the unit, press "Power/ Bidet"

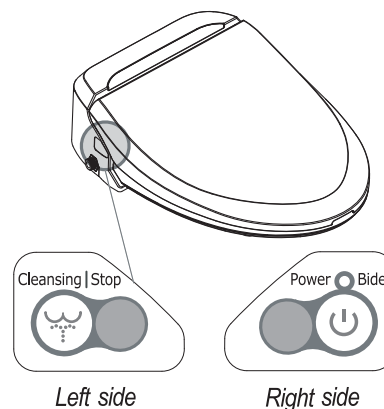
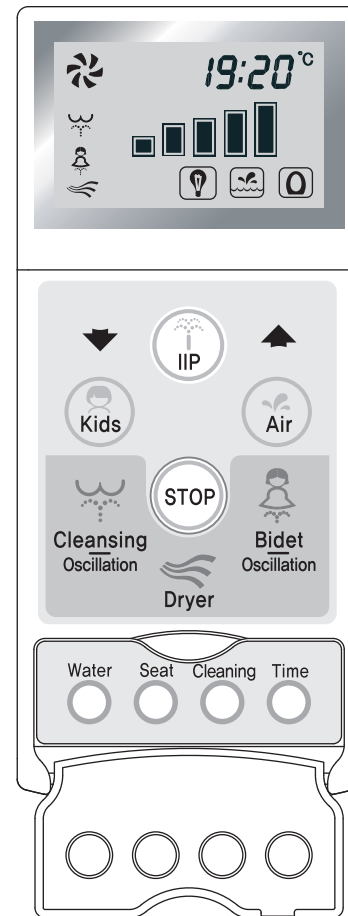

Identification

- Use this function when there is more than one unit of this product installed.
- To prevent interference among units, main unit and remote control should be set with the same ID.
- If there is only one unit in the bathroom, you do not need to set ID.
- Initial ID of remote control and main unit is "0". (12:00)
There are 16 ID (0 ~ 15)

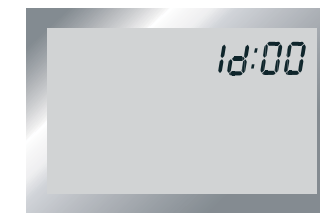

How to set ID

Remote control

- Press "Stop" for 5 seconds and 12:00 shows up in display.
- Press ▼▲ until your ID appears in display. (00 ~ 15)
- Press "Stop" again to set ID, and display will return to stand-by mode.

Main unit

- Plug in unit while pressing "Power/Bidet" on the main unit panel until unit beeps.
- Change ID by pressing "Cleansing/Stop".
- Press "Power/Bidet" again to set ID

Note

- If IDs of remote control and main unit are different, main unit will not work.
- ID will be re-set (12:00) if the power is unplugged or batteries of remote are replaced.

4 How to use UB-6235

※Caution

- All functions will be operational when the seat sensor is activated, except nozzle cleaning.
- Before operating, ensure that water tank is filled up completely.

Stop

- Press "Stop" to stop current operation.
- When a user stands up, all operations will stop automatically.

Cleansing

- Press "Cleansing" to clean your posterior. The function will stop in 60 seconds automatically.
- Press this button again to activate oscillation. The nozzle moves back and forth automatically to widen cleansing area.
- Oscillation wash stops if this button is pressed again.

Bidet

- Press "Bidet" for feminine wash. The function will stop in 60 seconds automatically.
- Press this button again to activate oscillation. The nozzle moves back and forth automatically to widen cleansing area.
- Oscillation wash stops if this button is pressed again.

Dry

- Press "Dry" after "Cleansing" or "Bidet".
- Warm air will operate for 3 minutes.
- To alter the air dry temperature press this button again.

IIP (intensive impulse pulsation)

- Press "IIP" for impulse pulsation massage spray. The function will stop in 60 seconds automatically.
- Press "IIP" again to change the pulsation mode.

Kids

- Press "Kids" to change all functions for children.
- 1 minute for oscillation and 3 minutes for dry, level 1 water pressure and level 5 nozzle position will be set.
- This unit should be used under the supervision of an adult.

Auto

- Press "Auto" during "Cleansing" operation. Wash, oscillation and dry will each operate for 20 seconds.
- For Auto Bidet, press "Bidet" and "Auto" consecutively.

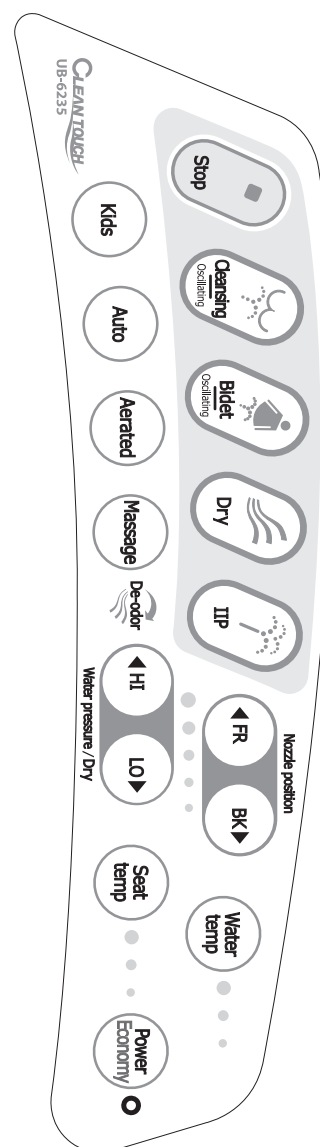

Self cleaning

- Nozzle self cleans before and after each use.

Self-diagnosis system

- This appliance has a self-diagnostic system.
- LED light will appear if malfunction.
- Unplug and contact service center immediately.

Aerated (aerated spray)

- Press "Aerated" to use aerated wash to clean. Gentle, delicate but strong water spray will save water consumption.
- Press this button again to release this function.
- In "cleansing" mode this function is always on.

Massage

- Press "Massage" to activate massage wash effect.
- Press "Massage" again to release this function.

Automatic deodorization

- Deodorizer works automatically when appliance is in use. (max 20 minutes)
- Stops 60 seconds after use.

Nozzle position

- Nozzle position can be adjusted 5 levels.
- Use "FR" "BK" buttons to adjust.
- Position default to level 3.

Water pressure / Dry temperature

- Press "HI" "LO" buttons to adjust water pressure. 5 levels
- Press "HI" "LO" buttons to adjust dry temperature. 5 levels
- Both levels default to 3.

Temperature adjustment (water / seat)

- Press "Water" or "Seat" buttons to adjust temperatures.
- 4 levels - room temperature, 34, 37, 40 degrees Celsius.

Economy

- Press "Economy" to activate power saving function.
- In Economy mode, water and seat temperatures are kept to 30 degrees Celsius.
- Green light on console will appear.
- When the unit is next used, temperatures will revert to default settings.
- Unit will revert to Economy mode after 1 hour of last use.
- Press "Economy" again to release this function. Red light on console will appear.

5 How to clean

Nozzle cleaning

Caution Do not forcefully push or pull the nozzles, or bend them. It may result in failure.
Make sure to use "Cleaning" button on the remote control.

- 1 Ensure seat sensor is not activated.
- 2 (UB-6235)
Press "FR" button to clean posterior nozzle manually.
Press "BK" button to clean feminine nozzle manually.
(UB-6035R)
Press "Cleaning" button to clean posterior nozzle manually.
Press this button again to clean feminine nozzle manually.
- 3 Use a toothbrush or soft cloth to clean nozzles.
Press "Stop", "FR" "BK" to return nozzle to stand-by mode.
For extended cleaning, unplug for safety.
- 4 Do not retract nozzles without a nozzle tip. It may result in malfunction.
- 5 Be sure nozzle tips are correctly in place.

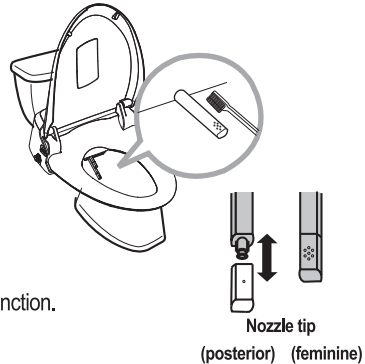

Nozzle tip
(posterior) (feminine)

Strainer maintenance

This appliance will not operate properly if the strainer is clogged.
Be sure to clean the strainer regularly.

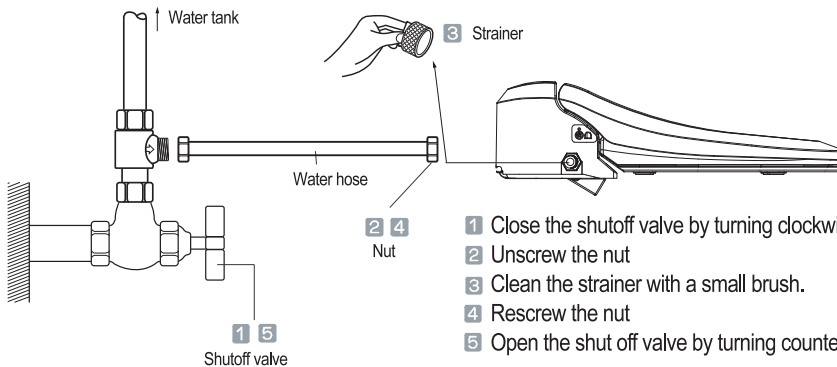

- 1 Close the shutoff valve by turning clockwise.
- 2 Unscrew the nut
- 3 Clean the strainer with a small brush.
- 4 Rescrew the nut
- 5 Open the shut off valve by turning counter clockwise.

Cleaning the body

- 1 Regularly wipe off the body with a soft cloth or sponge
- 2 Remove the lid.
 1. Raise lid slightly forward. Pull left hinge out and up.
 2. Release the right hinge Never force soft close lid or seat to close.
- 3 Do not clean this unit with toilet bowl cleaner or any abrasive chemicals. Use only a mild, neutral soap.
- 4 Always unplug unit when cleaning.



6 Maintenance

Draining water - while not using over extended period of time

- 1** Unplug the power supply cord.

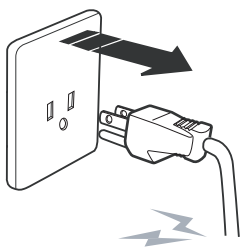

- 2** Close the shutoff valve.

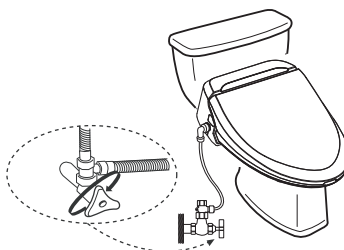

- 3** Detach the unit.
■ Refer to installation.



- 4** Upend the appliance and thoroughly drain the water by turning the drain bolt to open and removing.

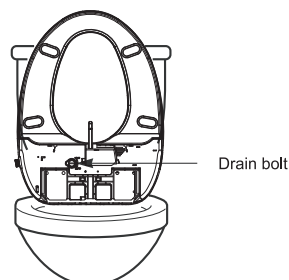

- 5** Reinstall the drain bolt and re-attach the appliance.
■ Refer to the trial operation method in order to use this appliance again.

Preventing freezing

- 1** Make sure the power cord is plugged in properly.

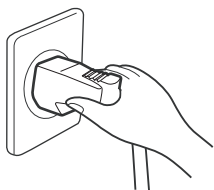

- 2** Set water temperature to low or middle.
■ If the washroom is not heated, wrap water hoses with cloth.

- 3** If unit will not be used for extended period, or if risk of freezing, unplug and drain the water from the water tank and pipes thoroughly.
■ Refer to draining water method.

7 How to install



Do not plug in until installation is finished completely.

If electric work is needed, contact to a qualified electrician.

Remove the existing toilet lid and seat

1. Remove the nuts, washers and cone packings from the toilet seat mounting bolts in the back of the toilet.
2. Remove the toilet seat, lid and mounting bolts.
3. Keep them in case installing again.

Install the appliance

Installation

How to mount the plate

Place the plate and guides over each mounting hole. Insert the mounting bolts through the plate and mounting holes, and slide cone packings and washers onto the bolts.

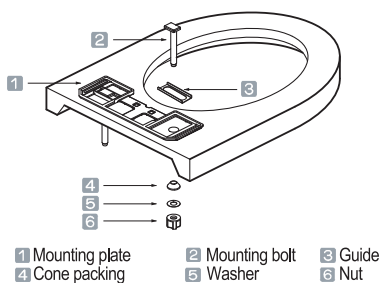

How to attach and detach the unit

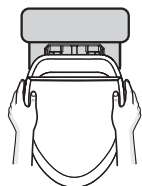

Slide the unit until it clicks into plate.



Lift the unit up and forward.

Toilet size (elongated & round front)

- The toilet dimensions must be within those shown below. Do not install this appliance on a toilet that does not meet these dimensional requirements.

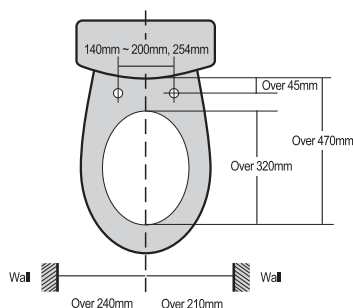

Seat sensor

- This appliance is equipped with a seat sensor.
- Unit will not work unless seat is occupied.

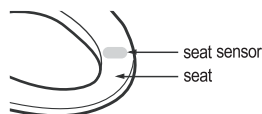

Check that all 4 seat pads are resting on ceramic bowl. If there is a gap 1/8" or greater, attach the spacers to seat pads.

Installation of remote control unit (UB-6035R)

How to Insert batteries

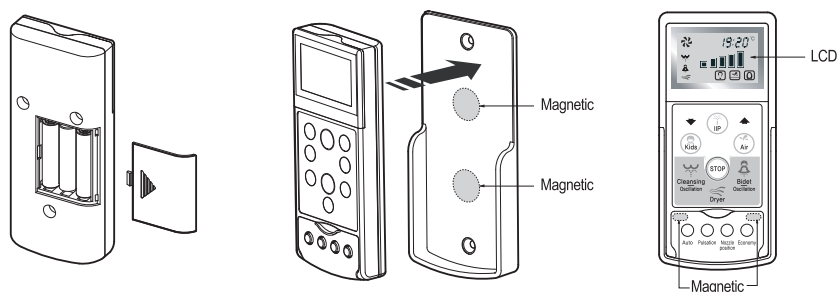

1. Open the battery lid of remote control and insert 3 AAA batteries into battery compartment.
2. Check the display appears properly.
3. Check the remote control works properly while seat is occupied.
4. Install the remote control bracket on the wall as shown below.

Note following precautions to prevent ruptured batteries and battery acid leakage.

- Use 3 AAA batteries only.
- Do not use old and new batteries together and same type of batteries only.
- Make sure that all batteries are inserted into their correct positions.
- Remove the batteries if the remote control is not used for a long time.
- LCD will fade or blink if the batteries reach the end of their life. Change the batteries immediately.
- Settings (time, power saving mode) will be lost when batteries are replaced.

How to attach remote control unit

Use double sided tape

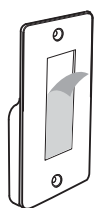

Use screw with plastic anchor

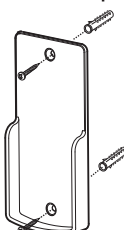

Recommended position of attachment

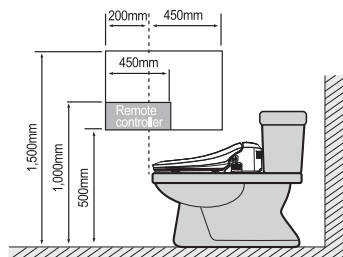

- Keep the remote control unit in the bracket to prevent damage by dropping.

Connecting the water hoses

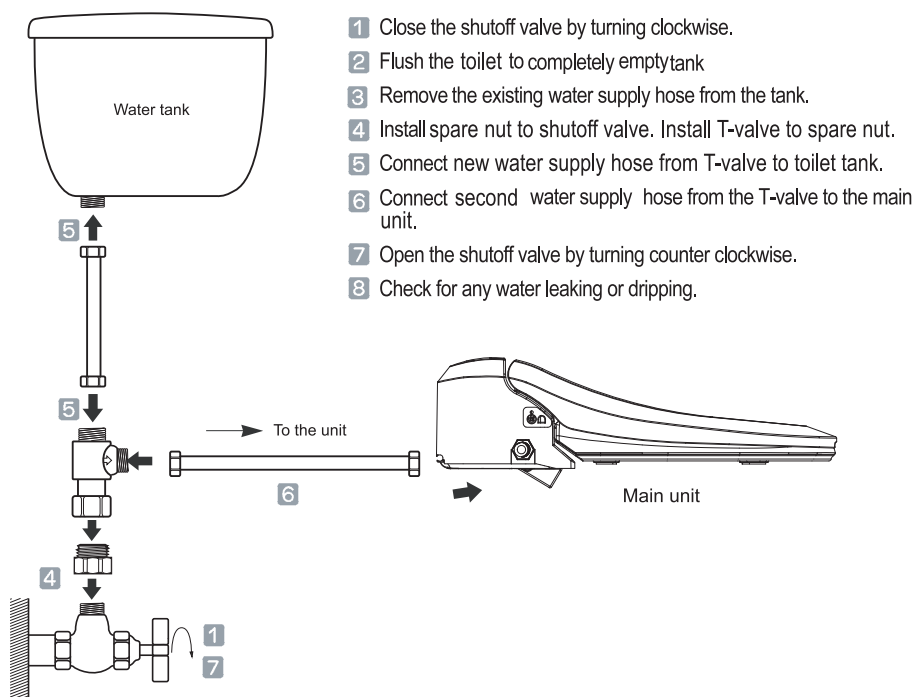

- 1 Close the shutoff valve by turning clockwise.
- 2 Flush the toilet to completely empty tank.
- 3 Remove the existing water supply hose from the tank.
- 4 Install spare nut to shutoff valve. Install T-valve to spare nut.
- 5 Connect new water supply hose from T-valve to toilet tank.
- 6 Connect second water supply hose from the T-valve to the main unit.
- 7 Open the shutoff valve by turning counter clockwise.
- 8 Check for any water leaking or dripping.

Trial operation

1. Preparation

Plug the power cord into GFI outlet.

Press "BIDET" or "CLEANSING", Main unit water tank will fill in 2 minutes.

Sound indicates main unit water tank is full.

2. Test

Cover the toilet bowl with plastic sheet to catch spray.

Press down lightly over seat sensor to activate.

Check for all functions.

All units are factory tested before shipping, there may still be some water present in the lines.

8 Troubleshooting

Problem	Possible cause	Solution
Completely fails to work	Is there power to the outlet? Is the cord unplugged? Are you sitting on the seat?	Check for outlet breaker or GFI failure. Plug the power cord in properly. Sit on the seat to activate seat sensor.
Water does not spray	Is the water shutoff valve closed? Is the strainer clogged? Are the nozzles clogged?	Turn on water shutoff valve. Clean the strainer. Clean the nozzles.
Water is leaking or dripping	Check all hoses are tightened properly	If water is still leaking or dripping, contact authorized distributor.
Seat, water or air is not enough warm	Is the temperature set to OFF? Is appliance in economy mode? Freezing temperature?	Reset the temperature. Release the economy function. See page 11.

9 Specifications

Item			UB-6035R	UB-6235
Standard power supply			AC 120V 60Hz 660W	
Water supply	Way of connection		Direct connection to tap water	
	Water pressure		0.08MPa ~ 0.75MPa	
Clean-sing	Spray for cleansing		900±100mℓ/min	
	Spray for bidet		900±100mℓ/min	
	Water capacity		800 mℓ	
	Spray temperature		Room Temp ~ 40°C (104°F)	
	Heater capacity		600W	
	Safety feature		Thermal switch, Temperature fuse, Floating switch	
Dry	Air temperature		Room temp ~ 60°C (140°F)	
	Heater capacity		250W	
	Safety feature		Temperature fuse	
Heated seat	Seat temperature		Room temp ~ 40°C (104°F)	
	Heater capacity		55W	
	Sefety feature		Temperature fuse	
Deodorization			Catalytic filter	
Circuit breaker			Within 15mA 0.03 second	
Length of power cord			1.2m	
Dimensions	Elongated	Remocon Type	(W)392mm X (L)520mm X (H)143	(W)15.43inch X (L)20.47inch X (H)5.62inch
		Control Type	(W)466mm X (L)520mm X (H)143	(W)18.34inch X (L)20.47inch X (H)5.62inch
	Round front	Remocon Type	(W)392mm X (L)500mm X (H)143	(W)15.43inch X (L)19.68inch X (H)5.62inch
		Control Type	(W)466mm X (L)500mm X (H)143	(W)18.34inch X (L)19.68inch X (H)5.62inch
Weight			4.4Kg(9.7lbs)	4.2Kg(9.25lbs)

※ Recommended water supply pressure (15 PSI - 100 PSI)

WARRANTY

Clean Touch Personal Hygiene Appliance Limited Warranty

- Manufacturer warrants products to be free from manufacturing defects under normal use and service for a period of one (1) year from date of your purchase. Only the ORIGINAL PURCHASER you may make a claim under this limited warranty.
 - Our obligation to you under this warranty is limited to repair or replacement, at our option, of defective products or parts, provided that the products were properly installed and used in accordance with instructions. We reserve the right to make inspections in order to determine the cause of the defect. We will not charge for labor or parts in connection with warranty repairs or replacement. We are not responsible for the cost of removal, return and/or reinstallation of products.
 - This limited warranty does not apply to:
 - a) Damage or loss from a fire, earthquake, flood, storm, etc
 - b) Damage or loss resulting from any unreasonable use, abuse, negligence, or improper maintenance.
 - c) Damage or loss from improper installation, removal, repair, or modification.
 - d) Damage or loss resulting from sediment or other matters contained in your water system.
 - This warranty gives you specific legal rights.
 - For warranty or service information, please contact authorized distributor.
 - Only the original purchaser may submit a claim under this limited warranty. Retain your receipt as proof of purchase.
 - This limited warranty is our only warranty covering your product. Repair or replacement as provided under this warranty shall be the exclusive remedy available to you. We shall not be responsible for loss of the product or for other incidental, or consequential damage or expenses you may incur or for labor or other costs due to installation or removal, or cost or repairs by others, or for any other expense not specifically stated above. Except to the extent prohibited by applicable law, any implied warranties, including that of merchantability or fitness for use, are expressly limited to the duration of this warranty.
- ※ Warning! We are not responsible or liable for any failure of, or damage to, this plumbing product or product component caused by in-tank bowl cleaners containing chlorine(calcium hypochlorite).
- ※ Note : The use of high concentration of chlorine related products can seriously damage the fittings. This damage can cause leakage and serious property damage.

For more information, please contact authorized distributor.

Purchase Date _____ Purchased From _____
Invoice # _____ Amount Paid _____ Serial # _____
Address _____ City _____ State _____ Country _____ Zip _____
Phone _____ Fax _____ E-mail _____

Authorized Distributor

Fraser International Trading Inc.
Tel :1-888-531-8383
email : fraserit@telus.net
web : www.cleanrevolution.com

Manufacturer :
SAMHONGTECH CO., LTD
Made in South Korea.

Great products for healthy living !